

Prime Laminate-Legend Collection

Installation Guide



Topdeck Flooring

Congratulations and thank you for choosing Prime laminate flooring.

We do our best to guarantee product quality when it's in our duty of care. Once it leaves our warehouse it's up to the 'customer' and the 'installer' to verify the condition of the product before or during installation as stated in our warranty. During installation the floorboards are cut and hit into place & some boards will suffer chips and scratches. This is why there is always wastage factored in all flooring installations. It's important for the customer and installer to share the responsibility & check the product and not to use any damaged product in the installation.

PRIOR TO INSTALLATION

- Floating floor installation only, not to be glued or nailed to the subfloor.
- Check the product matches what was ordered.
- Check the condition of the subfloor surface for flatness and planeness.

Refer to the **Horizontal surfaces** diagram.

Any deviations greater than 4mm over a 2 m radius as in A. B. C. must be corrected either by grinding the humps or using levelling compound to fill the low spots.

- Choose the best direction for the flooring to be installed, consider major light source, length and width of rooms.
- Work from a few boxes to mix in the desired patterns in the layout.
- Allow for expansion gaps around the perimeter of 8-10mm, & a maximum of 9 metres in the width of the plank, with an extra expansion gap of 1mm for every metre there on.
- Tapping blocks and pullbars are advised but never directly strike the board with a hammer or rubber mallet.

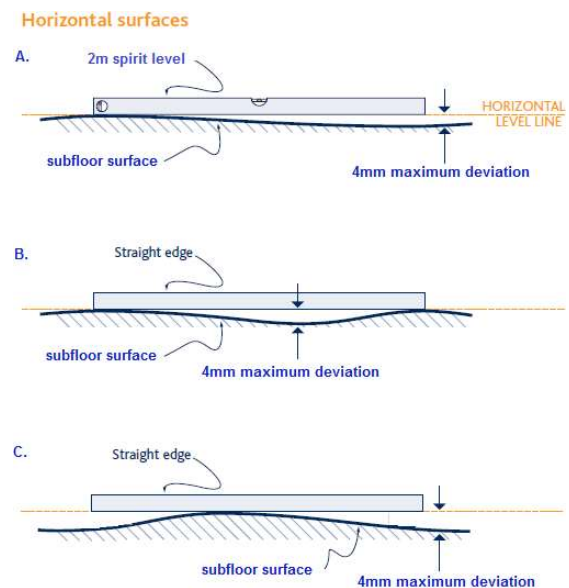

MAINTENANCE & CARE GUIDE MAIN POINTS

Prime laminate flooring can be cleaned with just a cloth, mop, broom or vacuum. When cleaning, make sure the cloth or mop is damp, but NEVER soaking wet. NEVER use a Steam mop, this will damage the floor and void the warranty. Surface dirt can be easily removed with a cloth or vacuum. Scuff marks and difficult stains can be removed just as fast and easily, simply wipe with a damp cloth. Please note that the cloth should be wrung out before wiping. In high-traffic areas with lots of dirt, such as entryways, mats will help to protect against abrasions. Furniture legs should be protected with felt pads to guard against scratching. Note that you can void your warranty should you not use felt pads. Standing water should be avoided at all costs. Take extra caution in areas with flowerpots, vases, and near water faucets. If you use any cleaning agents while cleansing the floor, make sure that all residues are removed.

The following cleaning agents are not suited for cleaning laminate flooring:

- Waxes
- Bleach
- Strong Solvents
- Abrasive polish that can damage the surface coating

INSTALLATION PROCEDURE

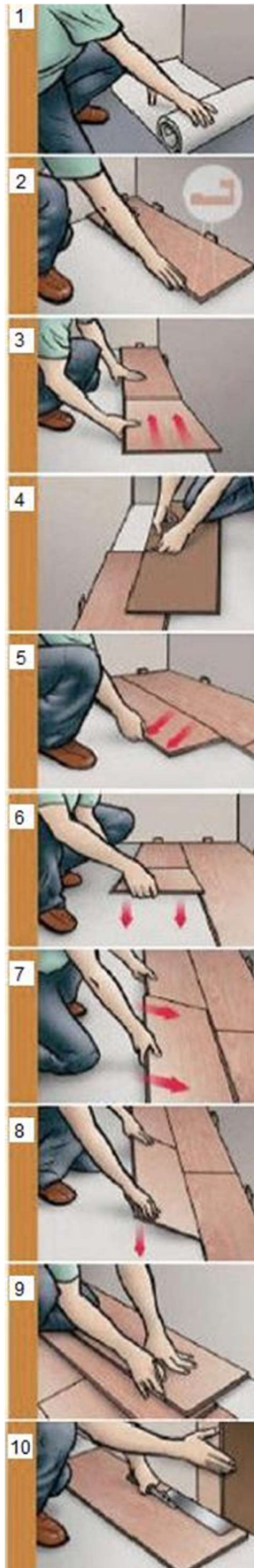

- REMOVE / SWEEP/ VACUUM ANY FOREIGN MATTER FROM SUBFLOOR
- INSTALL THE UNDERLAYMENT PERPENDICULAR TO THE FLOORING LAYOUT
- USE SPACERS FOR EXPANSION GAPS OF 8-10MM AROUND THE PERIMETER
- LAY THE FIRST BOARD WITH THE LARGER CLICK AWAY FROM THE WALL
- CLICK THE ENDS OF THE BOARDS INTO EACH OTHER
- CONTINUE PROCESS TILL THE OPPOSITE WALL
- MEASURE AND CUT THE LAST BOARD IN THE LENGTH TO COMPLETE THE ROW
- MAINTAIN EVEN EXPANSION GAPS OF 8-10MM AT THE WALLS END
- KEEP THE OFF CUT TO THE START OF THE NEXT ROW
- ONLY USE STAGGER LENGTHS BETWEEN END BOARDS OF A MIN OF 30CM
- USE THE OFF CUT TO BEGIN THE NEXT ROW STAGGER
- CLICK DOWN BOARD ENDS AS IN STEP 1 BUT DON'T FULLY CLICK INTO PREVIOUS ROW
- LIFT ON AN ANGLE AND PUSH THE ROW INTO THE PREVIOUS ROW
- NOW PUSH DOWN AND CLICK IN THE ROW INTO THE PREVIOUS ROW
- REPEAT STEPS 4 TO 8 TO COMPLETE THE LAYOUT
- MARK AND CUT THE BOARD IN THE WIDTH TO COMPLETE
- TO FIT THE LAST ROW USE PULL BAR AND TAPPING BLOCK WITH HAMMER IF REQUIRED
- UNDER CUT THE TIMBER DOOR FRAME AND SLIDE BOARD UNDER
- DON'T CUT METAL DOOR FRAMES BUT LEAVE AN EXPANSION FILL GAP WITH MATCHING COLOUR GAP FILLER COMPOUND
- USE SKIRTING BOARDS OR SCOTIA TO COVER ALL EXPANSION GAPS
- REPEAT PROCESS AS REQUIRED TO COMPLETE INSTALLATION

-End-